

community health center
viet village urban farm

home by hand

the green at columbia parc

grow dat youth farm

parasite skatepark

LOOP pavilion

skatepark at city park

eco pavilion

bayou road

storypod

idea village entrepreneurial center

janes place

columbus greenway

guardians institute

pyramid wellness

ride nola

circle food store

environmental center

greenline

hollygrove market and farm

broad community connections

A.M.I.A.C.T.

green project

house of dance and feathers

streetcar shelter

covenant farms

backstreet cultural museum

st. claude pocket park

all souls

lower 9 visioning coalition

project sprout

german schoolhouse

TCC community base

magellan street garden

lusher playground

a.l. davis park

vacant land management

greenbuild

URBANbuild 2-4

tulane school of architecture

delassize garden structure

1725 Baronne Street

A COMMUNITY BASED HOME FOR THE TULANE CITY CENTER

hung dao urban farm

hope farms hope haven

1725 Baronne St. Project

A COMMUNITY BASED HOME FOR THE TULANE CITY CENTER

A Project Of
THE TULANE CITY CENTER

A Collaboration With
THE TULANE SCHOOL OF ARCHITECTURE
And
GULF COAST HOUSING PARTNERSHIP

Sponsored By :
ALBERT SMALL, JR. (Tulane A&S '79)
H. MORTIMER FAVROT, JR. FAIA (TSA '53)
and JOHNSON CONTROLS, INC.



ENGAGE



DESIGN



FABRICATE



CELEBRATE

TABLE OF CONTENTS

4	Who We Are and What We Do
7	Vision and Project Overview
8	Project Specifics
10	Design Concept
12	Building Plan and Program
17	Opportunities to Support
18	Acknowledgments

WHO WE ARE & WHAT WE DO

The Tulane City Center's mission is to educate, advocate and provide design services to New Orleans neighborhoods and non-profit clients who are traditionally under-resourced and underserved by the design disciplines. We believe in the necessity of design and its broad access by all citizens as a basic democratic right. As a result, our work is characterized by deep citizen engagement in the planning and design decisions that will affect their lives.

As the principal venue for outreach projects at the Tulane School of Architecture, the Tulane City Center (TCC) enjoys a broad range of partnerships with numerous off-campus community-based organizations. Each partnership provides opportunities for faculty and students to engage real issues in the community and to participate in the life of our city. The TCC works on projects ranging in scale from small neighborhood gathering spaces to urban scale neighborhood planning processes and always recognizes the importance of thinking beyond the scale of the individual project.



tulane city center

Project Types

Typical Team Composition

Percentage of all Projects





COMMERCE ON OC HALEY

- Office
- Retail
- Culture
- Mixed Use
- Future Projects

- Church Alley Coffee
- Myrtle Banks School
- New Orleans Redevelopment Authority
- New Orleans Jazz Market
- Southern Food and Beverage Museum
- Juvenile Justice Project of Louisiana
- Youth Empowerment Project
- Gulf Coast Housing Partnership
- Cafe Reconcile
- Ashe Cultural Arts Center
- German Schoolhouse
- Ashe Cultural Arts Theater
- Tulane City Center
- Franz Building
- Tulane City Center

VISION & PROJECT OVERVIEW

The Tulane City Center (TCC) is the principal community outreach and research arm of the Tulane School of Architecture, connecting design students and faculty to local non-profits and neighborhood groups to work collectively on projects with a public interest and impact. The TCC has been operating out of the Tulane School of Architecture's uptown home since the TCC was started in 2005. In 2013 we opened our first satellite office in Spring 2012 on OC Haley Blvd in Central City. The new location provided much needed off-campus space to meet with community partners, as well as collaboration space for staff and interns. We also hosted several events there, including pecha kucha nights where students and colleagues could learn more about our projects.

In Fall 2013, Tulane City Center, teamed up with developer Gulf Coast Housing Partnerships to begin construction on our new permanent office on Baronne Street in Central City. The new location will provide ample workspace for staff, fellows, and interns as we expand our team, as well as community based project studio space for courses such as the Engage.Design. Build studios. The building will also house community events and resource space as well as a fully outfitted shop space for fabrication and staging of built projects. Most importantly, this new office helps to bring TCC geographically closer to our project sites and partners, as we seek to strengthen our existing relationships and forge new relationships with community members, non profits, and government agencies.

SETTING UP SHOP, IN THE COMMUNITY

In our first eight years as a community design resource community partners visiting our office or attending a charette had to contend with the parking issues and unfamiliarity of a sometimes intimidating college campus. Our temporary 300 s.f. satellite office space on OC Haley Blvd has allowed the TCC team a level of accessibility and visibility in the community that had been lacking on campus.

Building on the benefits of a community based home The Tulane City Center is moving into an off campus facility with community, studio, and shop spaces that will allow our staff, faculty, and students to have an even larger impact in the community. This new home signals our commitment to the city through revitalizing a blighted historic building along a commercial corridor, and brings our team out into a visible and active community base where we can more easily reach the communities we work with.

PROJECT

1725 Baronne is the community based headquarters of the Tulane City Center. Currently under construction, the 7,000 s.f. building will house three design studios, a fabrication shop, community meeting and presentation space, as well as offices and support spaces.

GOALS

In moving to an off-campus home, the Tulane City Center aims to make a more accessible community design resource, to increase our impacts in the community, and through working with community partners on projects provide more unique educational opportunities for the students of the Tulane School of Architecture.

LOCATION

Located in Central City, a centralized location within the city, 1725 Baronne is one block for the historic Oretha Castle Haley Boulevard home to a number of non-profits and city agencies. The Building is strategically located between Tulane's uptown and downtown campuses and is accessible by Tulane Shuttle, city bus and streetcar lines. Strategically located near the historic Oretha Castle Haley Commercial Corridor, the City Center's new home on Baronne Street is in a centralized location which is easy to reach from any of the city's neighborhoods, and is just blocks away from non profits, city agencies, and new commercial development along OC Haley Boulevard.

HISTORY

1725 Baronne Street was once part of the sprawling Kauffman's department store, one of the biggest stores in New Orleans in the early 1900's. It was founded and run by a German Immigrant. The building was one of many along the thriving Central City Dryades shopping district, an area that was a more inclusive shopping district welcoming African American, Jewish, Irish residents, and many other segments of the New Orleans community who were not fully welcomed in the Canal street shopping district.

PARTNERS

The Tulane City Center is working with Gulf Coast Housing Partnership, the developer on the project. The mission of Gulf Coast Housing Partnership to revitalize the Gulf Coast through transformative development and aims to create vibrant, high quality communities which are socially and economically integrated, affordable and sustainable.

Mention Sonny Small?



KAUFFMAN DEPARTMENT STORE, 1725 BARONNE STREET

DESIGN CONCEPT

The design of 1725 Baronne includes a large community space on the streetfront which will be used for presentations, design charrettes, gallery showings, and workshops that are available to the public. At the building's core are design studios, a large open space which encourage interaction and collaboration amongst the three studio groups that will be housed in the building. At the rear of the building is a shop space from which to stage and support the design build projects that the School has underway in the New Orleans community, currently 3-4 projects per year. Additionally, the building has a number of meeting spaces from a conference room to a less formal outdoor courtyard and offices to accommodate a flexible range of uses.



PROGRESS PHOTOS



PROGRAM

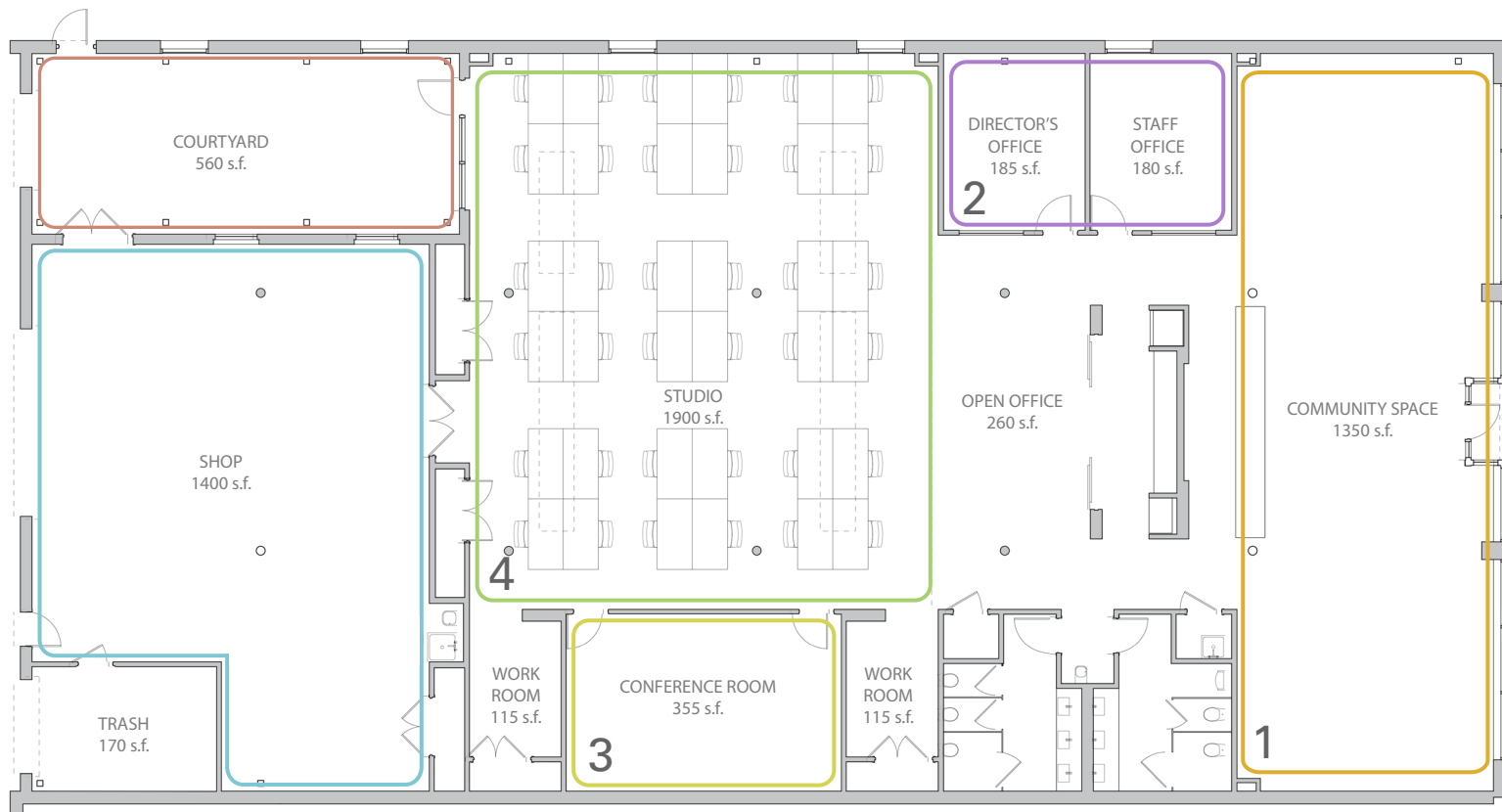

GROUND FLOOR PLAN



Space: Community Space
Purpose: presentations, charrettes, flexible space
Users: community members, non-profit parnters, faculty, students, staff
Area: 1350s.f.

1



Space: Studio
Purpose: design space, course based project space
Users: students, faculty
Area: 1900s.f.

4



Space: Offices
Purpose: project management, workspace
Users: staff, faculty, community collaborators
Area: 360s.f.

2



Space: Courtyard
Purpose: alternative meeting space, break space, mock-up yard
Users: staff, faculty, students, community collaborators
Area: 560s.f.

5



Space: Conference Room
Purpose: meetings, presentations
Users: community, students, faculty
Area: 355s.f.

3



Space: Shop
Purpose: fabrication space for design and design build studios
Users: students, faculty, staff
Area: 1400s.f.

6



STUDIO

The Studio will be a 1,900 square foot space that will host Tulane City Center design/build studios as an extension of the Uptown Campus. It will be a valuable space for design/build projects, not only because of its proximity to the O.C. Haley neighborhood, but because of its direct connection to its own shop, conference rooms, gallery space, and computers. The studio will be able to host up to two studios at once, which allows the opportunities for communication, collaboration, and education between the students and professors.





COMMUNITY SPACE

The Tulane City Center Community Space will be a multifunctional space that will host many functions that promote academic engagement, both with the neighborhood, as well as with the students, professors, and other community leaders. It will work primarily as a lobby, with a potential to host a coffee shop, bookstore, and other retail to invite and engage the community. Additionally, the space will host a great deal of events and work as a gallery and exhibition space. The Community Space will work as a connection between the O.C. Haley neighborhood and the Tulane City Center through various programs and events.



SHOP

The new TCC shop will be a 1,400 square foot fabrication space with new state-of-the-art power tools, workbenches, and other shop necessities. The shop has direct access to the adjoining courtyard, which can work both as a loading and storage area for materials, as well as a space for prefabrication and design. This space will be beneficial to the design/build studios, allowing mock ups, fabrication, and construction for these community based design build projects.



COURTYARD

The courtyard space is another multifunction space in the project. It works as an extension of both the studio and the shop, providing daylight to both. Not only can it function as a nice exterior break space for students and professors, but it can also work as an area for prefabrication and design. Additionally, the North end of the space has a garage door that allows for easy loading and unloading. The space has the potential for green walls, recreation, prefabrication, and more.



OPPORTUNITIES TO SUPPORT

As an outreach organization devoted to creative investigation of complex urban issues, we are committed to a wide range of relationships and are eager to facilitate connections between those with skills and support to offer and those who can make use of such help. We do not compete for work with professional architectural or design firms. Instead, we endeavor to demonstrate the value of good design in venues not often touched by standard models of professional practice and, in so doing, support the growth of the design sector in our communities. Functioning as a not-for-profit organization, the TCC maintains the complimentary goals of progressive design, applied research excellence, and advocacy for a better quality of life for all people.

Please do not hesitate to contact us if you are interested in supporting our move into a community space, or to discuss possible collaboration on future projects. As a grant funded center, we also welcome the opportunity to speak with any persons or organizations interested in supporting our work.

EMAIL: Maurice Cox: maurice@tulane.edu

Nick Jenisch: njenisch@tulane.edu

Dozenia Marshall: dmarsha@tulane.edu

Emilie Taylor: etaylor2@tulane.edu

ACKNOWLEDGEMENTS

DEVELOPER

Gulf Coast Housing Partnerships (GCHP)
www.gchp.net
contact: Kathy Laborde
email: laborde@gchp.net

TULANE CITY CENTER TEAM

contact: Maurice Cox, Director
maurice@tulane.edu
Emilie Taylor, Design Build Manager
etaylor2@tulane.edu

SUPPORTERS

Albert Small, Jr. (Tulane A&S '79)
H. Mortimer Favrot, Jr. FAIA (TSA '53)
Johnson Controls, Inc.